

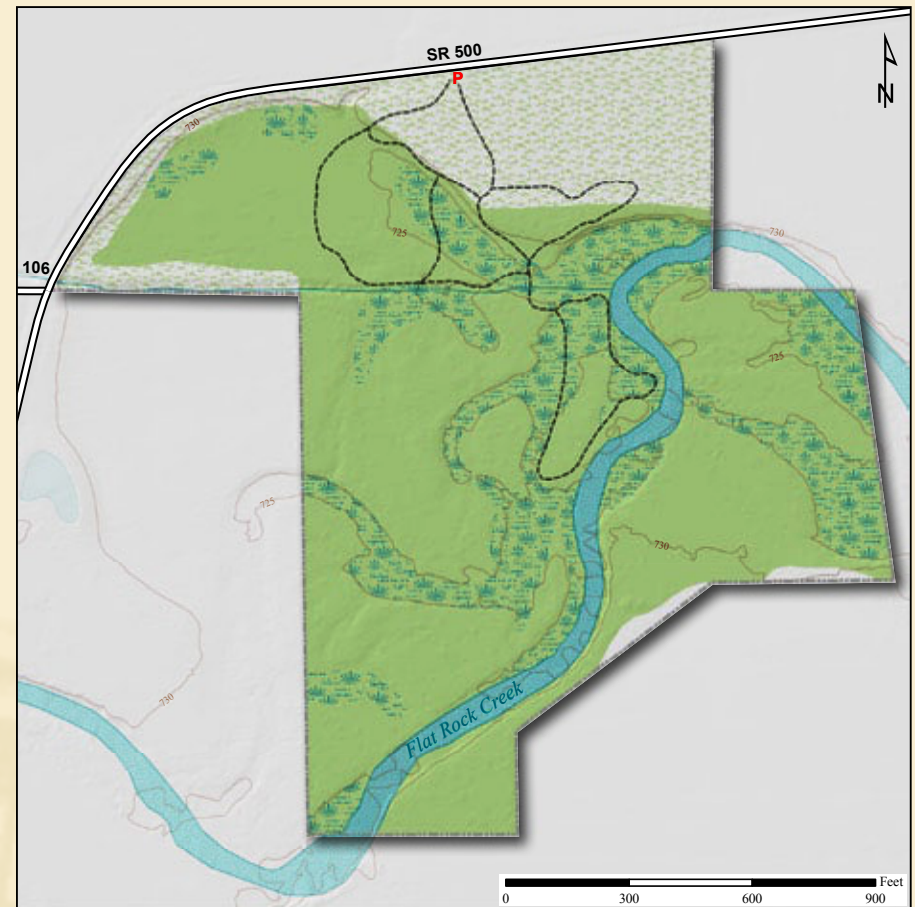

Latitude: 41° 32' 25"N Longitude: 84° 56' 45"W



Marbled Orb Weaver Spider

**Acreage: 50.0**

**Year Acquired: 2008**

This preserve contains upland and floodplain forest and is divided by the serpentine flow of Flat Rock Creek. The creek and mature forest attract abundant wildlife and provide great scenic vistas. Flat Rock Creek is one of very few unaltered creeks remaining in the area, its meandering course directed only by its own movement through the centuries.

**Directions:**

From Payne, Ohio, take SR 613 (east) until it joins SR 500. Continue on SR 500 (northeast) towards Paulding. Preserve is approximately 4 miles from Payne on the right. Preserve is 2.2 miles beyond the point where SR 613 splits from SR 500.

