

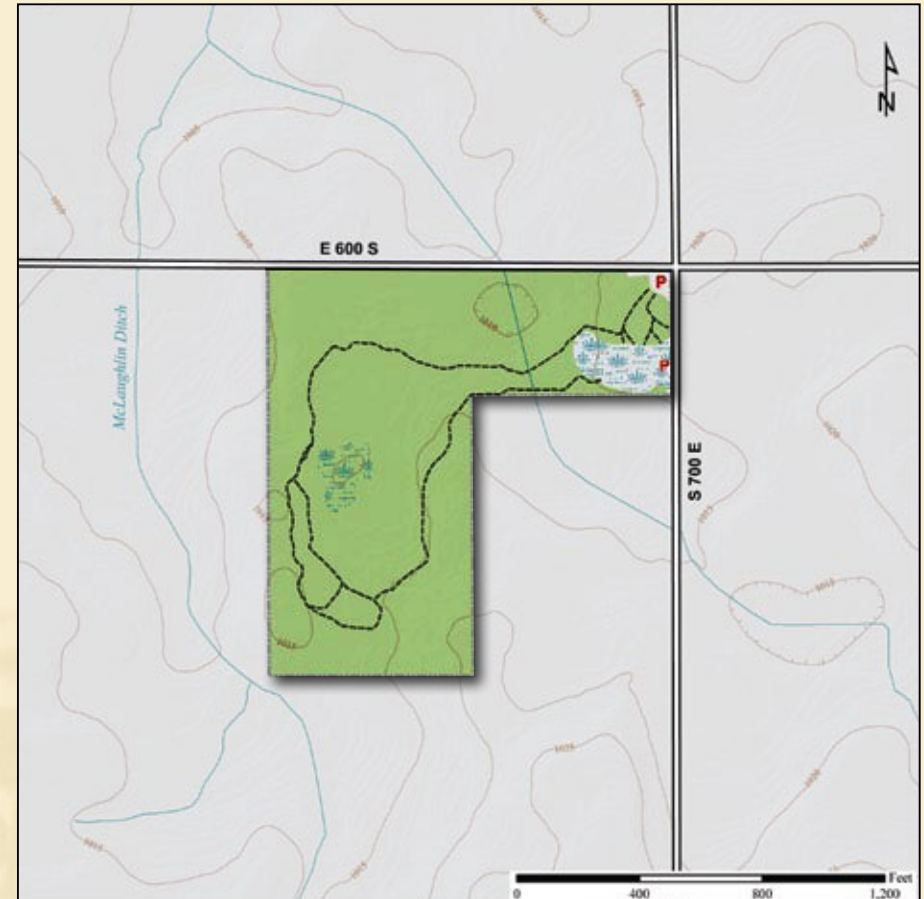

Latitude: 40° 21' 10"N Longitude: 84° 50' 37"W



Acresage: 27.3
Year Acquired: 1994

From 1854 to 1975, students attended school at this site, first in a log cabin, then a "modern" school built in 1923. Now, a boulder with an inscription commemorates the school, and sugar maple, ash, hickory and oak trees grow where students once played. There's an understory of smaller trees, shrubs and wildflowers. Slowly the trees are maturing, and through natural succession, the other vegetation is changing.

Directions:
From Portland, take US 27 south 5 miles to 500S and turn left (east). Travel 7 miles to 700 E and turn right (south). Preserve is in 1 mile at the corner of 700E and 600S.

